

ANIMA Washbasin with foot operation

MODEL RANGE: ANIMA | LP21 | 203.0498.353

Washbasins & Washtroughs | Wash basins

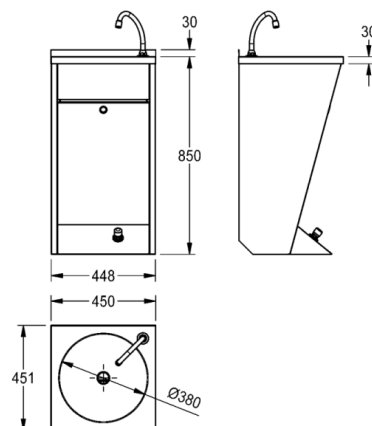

Single wash basin, floorstanding, wall mounting, stainless steel, surface satin finished, material thickness 1 mm, seamless welded round bowl with diameter 380 mm, rectangular shape, 35 mm tap ledge, without overflow, 1 1/4" plug waste, drainage centric, incl. premounted spout, floor standing trap cover with premounted self-closing valve for foot operation, water temperature adjustable with valve, front cover can be removed, includes screws and dowels.

Dimensions 450 x 880 x 451 mm (W x H x D)

Bowl Dimensions 380 x 150 mm (W x H)

Technical data

Bowl depth	150.00 mm
Bowl width	380.00 mm
Bowl width	380.00 mm
Material thickness	1.00 mm
Overall depth	451.00 mm
Overall height	880.00 mm
Overall width	450.00 mm
Waste hole projection	225.00 mm
Tap hole diameter	35.00 mm
upper edge of basin height	850.00 mm
Material	Stainless steel
Material code	1.4301 Chrome Nickel steel V2A
Tailor made	No
Tap hole position	Right
Tap ledge	No
Type of mounting	Wall and floor mounting
Waste hole position	Center
Bowl position	Center
Bowl finish	Satin finish
Bowl shape	Circle
Colour	No colour
Number of bowls	1.00000
Overflow	No
Rear upstand	No
Siphon included	No
Splash back	Component of another part
Surface finish	Satin finished
Number of tap holes	1.00000
Type of waste kit	Plug waste
Waste kit included	Yes
Waste size	DN 32
Spillway	No
Siphon diameter	DN 32
Splash back height	30.00 mm
Type of basin	Vanity basin
Franke Water Systems ws-info.uk@franke.com www.franke.com 2021-03-25	
Product code	203.0498.353



FRANKE